

Options (Unit : mm)

Finger guards

Model : 109-049C Color : Nickel-chrome plating (silver)

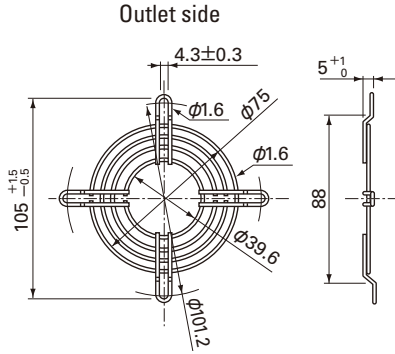

Resin finger guards

Model : 109-1002G

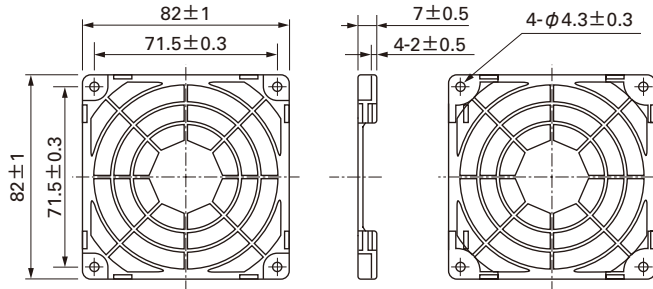

Model : 109-049E Color : Nickel-chrome plating (silver)
: 109-049H : Cation electropainting (black)

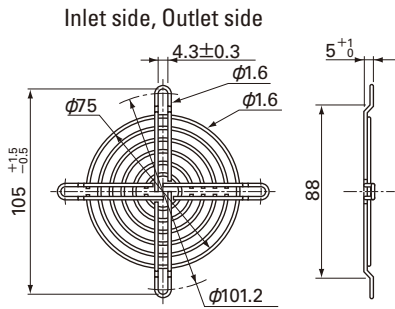

Resin filter kits

Model : 109-1002F13 (13PPI), 109-1002F20 (20PPI)
: 109-1002F30 (30PPI), 109-1002F40 (40PPI)

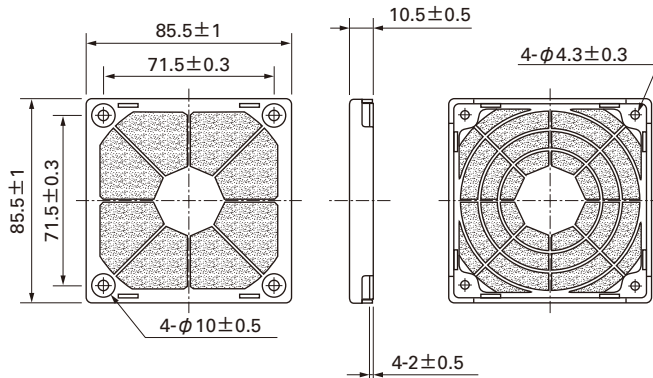

Plug cord

(Products compliant with Electrical Appliance and Material Safety Law)
Model : 489-008-L10/489-008-L21/489-008-L35

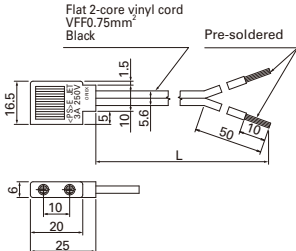

Model	Power cord length(mm)
— L10	1,000
— L21	2,100
— L35	3,500

Air Flow - Static Pressure Characteristics

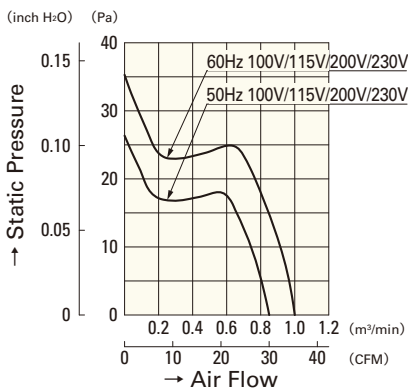

109-040UL
109-043UL
109-041UL
109-044UL

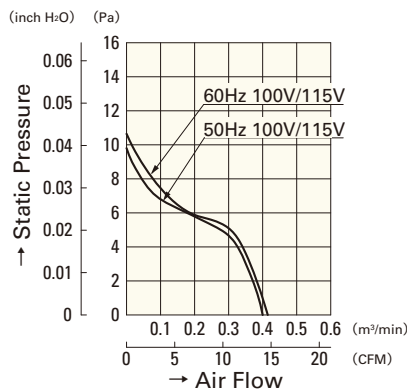

109-047UL
109-033UL